

ITEM	QUANTITY	CATALOG NUMBER	DRAWING NUMBER	DESCRIPTION	ITEM	QUANTITY	CATALOG NUMBER	DRAWING NUMBER	DESCRIPTION
1	1	06100002	--	V-BELT 3VX-280	25	1	07530019	--	ALTERNATOR 12V #321 39
2	3	06100008	--	V-BELT/ 3VX-425	26	1	02100002	--	BRG/PB2 DODGE SC 1.000"B
3	1	06100015	--	V-BELT/ 3VX-710	27	1	WF033710	220-0261	PINCH BAR
4	1	08120085	--	BELT/ACCULINK A25	28	1	WP163711	220-0282	SEAL/DRAAG-BRUSH
5	2	02110002	--	BRG/FG2 DODGE BALL SC 1.000"B	29	1	F000382	220-0223	IDLER ASSEMBLY
6	2	08300035	220-0052	RETAINER/SIDE SEAL	30	1	06300030	--	BUSHING/ TAPERLOCK #1610 X 17MM
7	1	08300059	220-0078	RETAINER/FRONT SEAL	31	1	06300024	--	BUSHING/TAPERLOCK 1610 X 1.00 / DODGE #117159
8	1	08300063	220-0080	RETAINER/REAR SEAL	32	1	06300052	--	BUSHING/2517 x 1.125"DIA T/L
9	1	P000528	220-0014	COVER-PLATE/BLAST HOUSING	33	1	06150001	--	SHEAVE/MOTOR 1A 4.6"DIA
10	1	P000528	220-0015	INSPECTION COVER/BLAST HOUSING	34	1	06150002	--	SHEAVE/ 1A5.256.8-1610 X 17MM T/L
11	1	WP103713	220-0210	LINER/GPX10-18 PINCH BAR BLAST HOUSING LOWER BACK WALL	35	1	06150031	--	SHEAVE/TAPERLOCK 3/3V4.75-1610 DODGE #112205
12	2	08300170	220-0255	SEAL/SHAFT - 1.00" BEARING	36	1	06150045	--	SHEAVE/MOTOR 8.00" 4 GR 3V T/L
13	1	WP113721	220-0238	LINER/TOP CURVED SLL	37	3	08300172	220-0189	SEAL/BLADE KEEPER
14	2	20090001	220-0267	PROTECTOR RING	38	3	WP123714	--	RETAINER/BLADE
15	1	WP043710	220-0254	LINER/LOWER FRONT - SLL	39	6	03110010	--	SCREW/CAP FLAT HEX SOCKET 1/4"-20UNC
16	1	WP043703	220-0255	LINER/UPPER FRONT SLL	40	2	P001083	--	BRG/FG2 DODGE DL 1.000"B 205 D-LOK
17	1	WP103710	220-0260	LINER/PINCH BAR SLL	41	1	08300173	220-0190	SEAL/PINCH BAR
18	1	WP123718	220-0007	BLASTWHEEL/DOVETAIL	42	1	06150003	--	SHEAVE 1GR3V 5.0-1610 T/L
19	1	WP013714	220-0002	BLADE-SET/DOVETAIL 10"	43	2	06300025	--	BUSHING/1610 x 1.125" DIA. T/L
20	1	08300107	220-0124	SCREEN/SHOT HOPPER	44	1	06150007	--	SHEAVE 1GR3V 6.9-1610 X 1-1/8" T/L
21	1	08300100	220-0117	TRAY/SHOT	45	6	09420001	--	ELEMENT/FILTER
22	1	08300131	220-0148	HALF-PIPE WELDMENT					
23	2	SL023506	220-0256	SEAL-KIT/SIDE					
24	1	SL023507	220-0257	SEAL-KIT/FRONT					

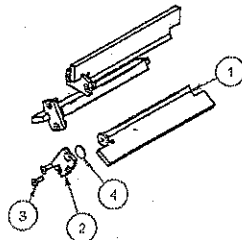
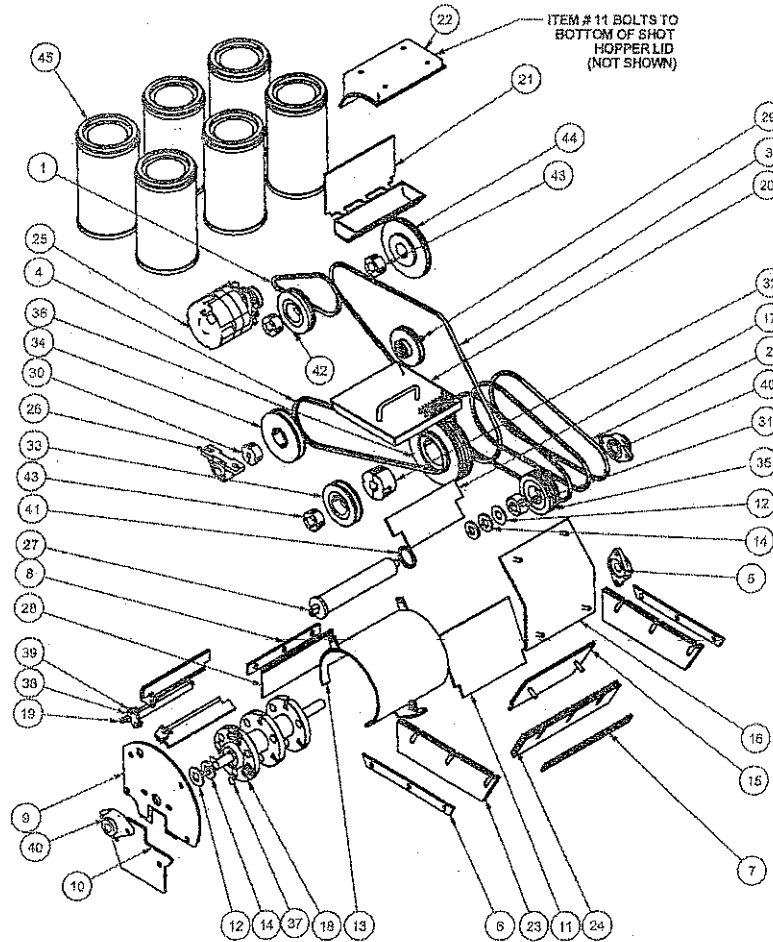

WKIT1018 - BLADE KIT

ITEM	QUANTITY	CATALOG NUMBER	DRAWING NUMBER	DESCRIPTION
1	1	WP013714	220-0002	BLADE-SET/DOVETAIL 10"
2	3	WP123714	--	RETAINER/BLADE
3	6	03110010	--	SCREW/CAP FLAT HEX SOCKET 1/4"-20UNC
4	3	08300172	220-0189	SEAL/BLADE KEEPER

ITEMS #20, #37, #38, AND #39 IN THE ABOVE ASSEMBLY ARE INCLUDED IN THE BLADE KIT. WHEN ORDERING REPLACEMENTS FOR THESE PARTS USE PART NUMBER WKIT1018.

GPXP10-18 WEAR PARTS
(PINCHBAR / DOVETAIL WHEEL)

BCSP-0003

4/11/2003

CUSTOMER SERVICE: 1-800-256-3440

BLASTRAC